

DK A-30 DTF Printer Installation Manual

Disclaimer

This installation procedure, using Hanrun Paper DK A-30 0.3-meter XP600 single-head four-color DTF printing machine as an example, will illustrate how to quickly assemble the printer. If your machine differs in width and type or number of print heads, you can still use this as a reference.

Note: This manual is provided for reference during the assembly process. It is recommended to have experienced professionals carry out the assembly operation!

Index

1. Machine Schematic	2
1.1 Front View	2
1.2 Rear View	2
2. Printer Assembly	3

1. Machine Schematic

1.1 Front View



1.2 Rear View

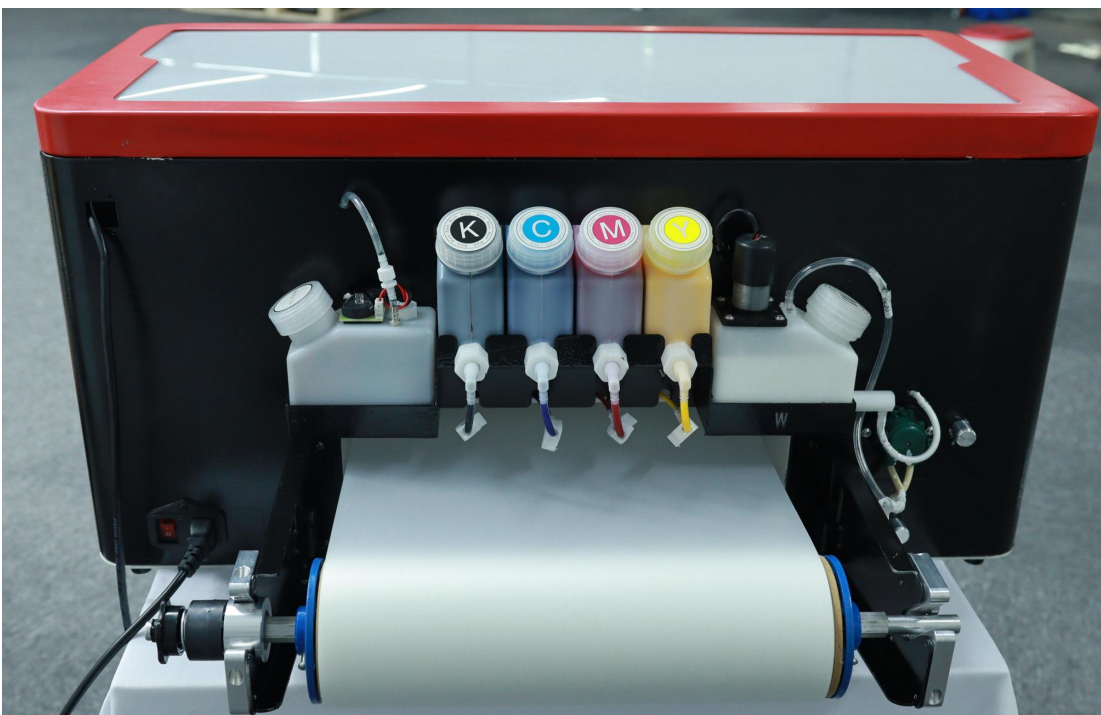

2. Printer Assembly

2.1 Installation of the unwind bracket.

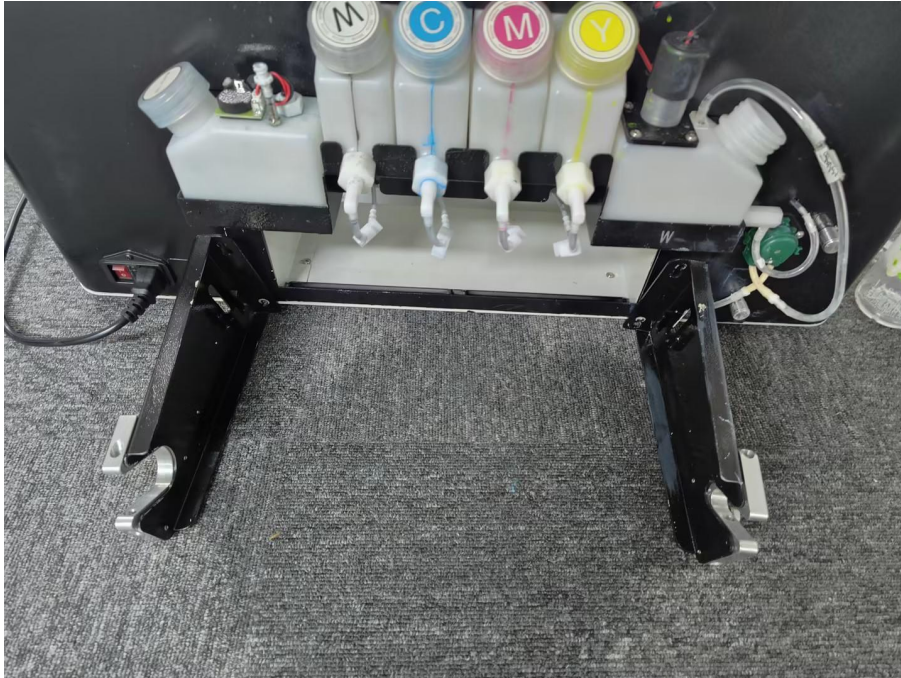

2.2 Installation of the ink bags.

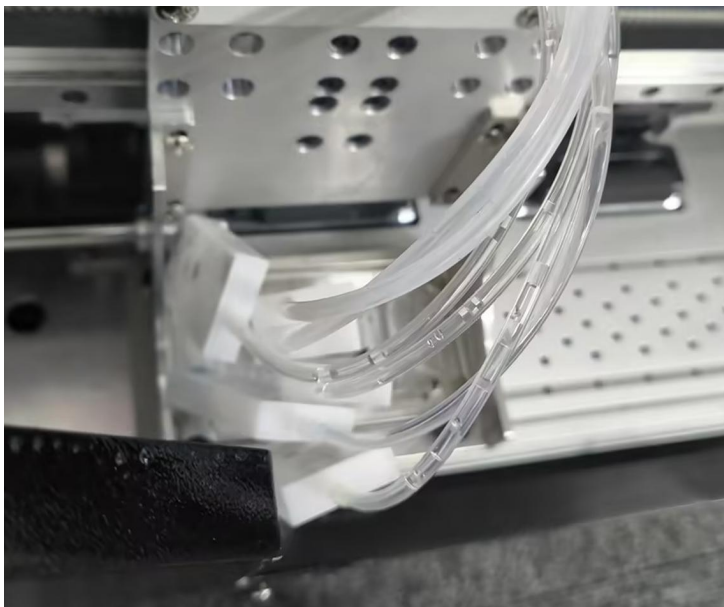

2.3 Installation of the printhead, paying attention to the left and right sides.

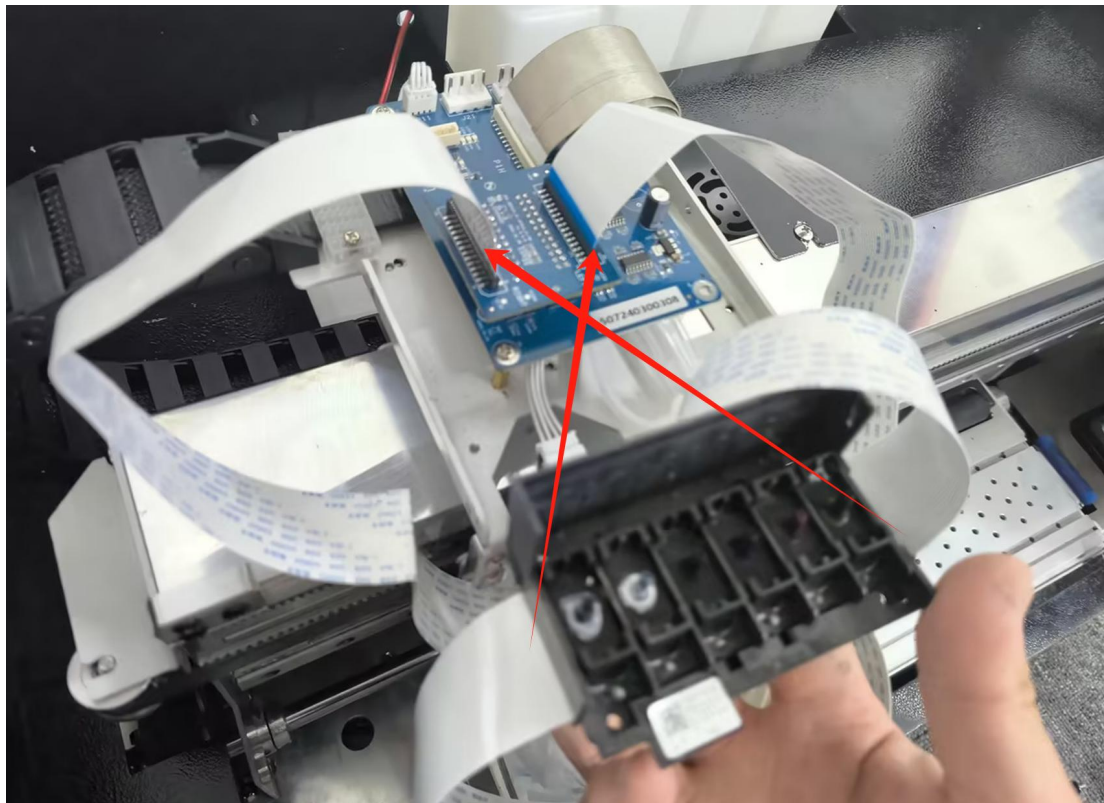

Note: This instructional material is provided by Hanrun Paper for your convenience during installation and should be used as a reference only.